



Gateway

SIEVE & CHAFFER SYSTEM

Parts Book

Four Panel, Single Adjustment Frames

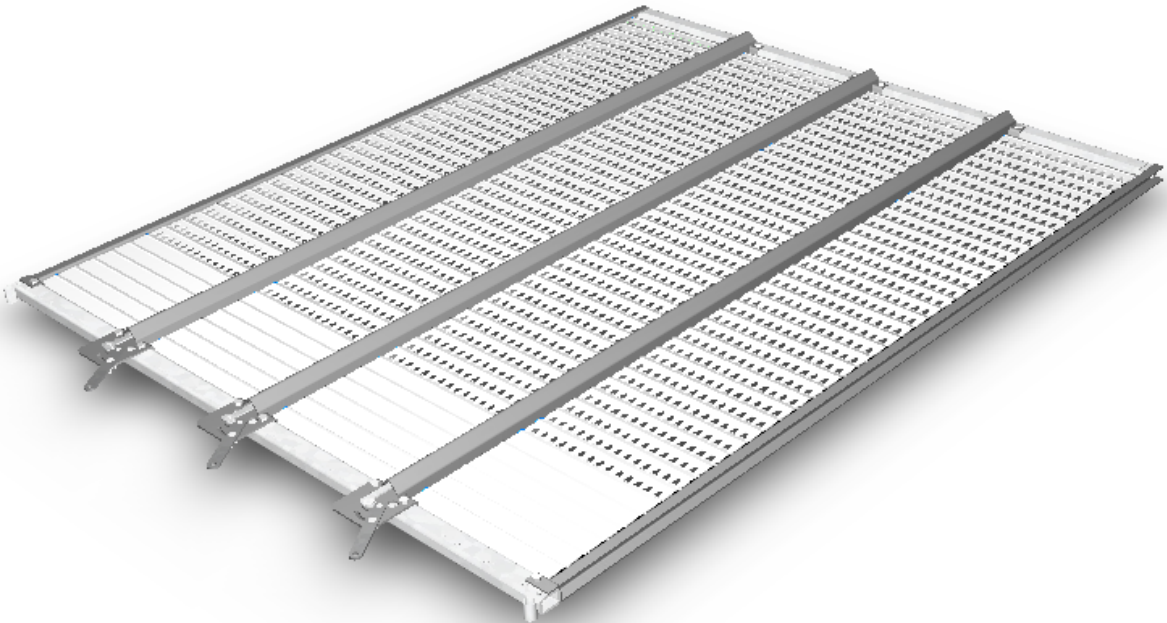

GATEWAY DIAGRAM

The Gateway diagram on this page is generic, covering a wide variety of OEM equipment. A detailed parts list is available on the following page(s) for each specific sieve.

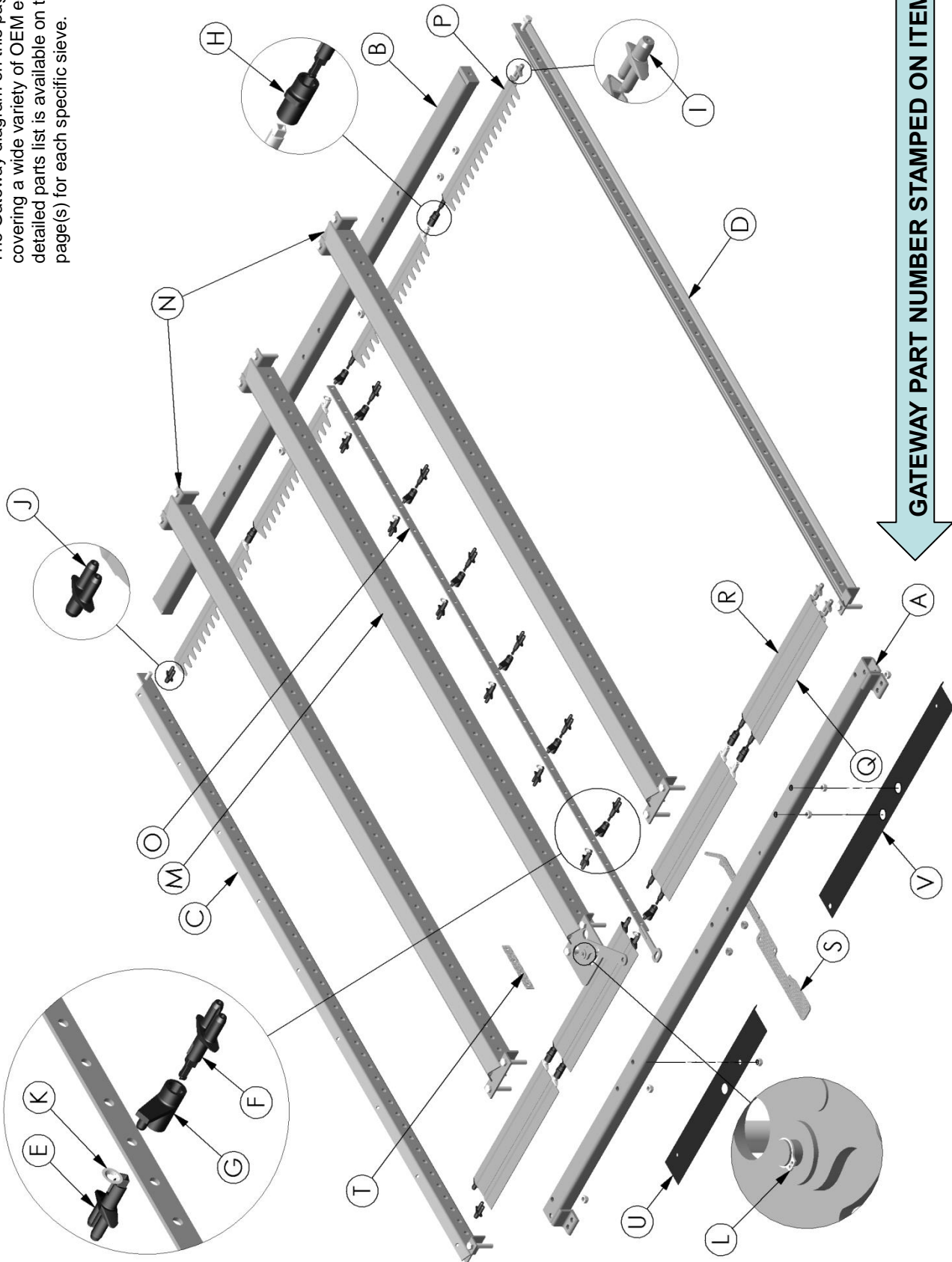



SERVICE PART LIST

PART NUMBER: 002570

REVISION I.D. : B

DESCRIPTION: GLEANER R62, R65, R72, R75 CHAFFER

<u>ITEM</u>	<u>QTY.</u>	<u>PART NUMBER</u>	<u>DESCRIPTION</u>
A	1	709180	REAR TUBE ASSY
B	1	709179	FRONT CHANNEL ASSY
C	1	709161	SIDE CHANNEL ASSY. - LH
D	1	709162	SIDE CHANNEL ASSY. - RH
E	135	409000	AXLE CONNECTOR - FEMALE
F	135	409001	AXLE CONNECTOR -MALE
G	45	409002	CRANK ARM - LONG
H	90	409003	CRANK ARM - SHORT
I	45	409004	END CRANK - R.H.
J	45	409005	END CRANK - L.H.
K	7	212366	PUSHNUT - .250 STUD DIA.
L	1	222040	SNAP RING
M	1	709164	DIVIDER ASSEMBLY
N	2	709165	DIVIDER ASSEMBLY
O	1	709166	ADJUST. BAR ASSY
P	176	409219	CHAFFER SLAT
Q	4	409220	FLAT SLAT ST
R	-	-	-
-	2	202191	BOLT - HEX
-	8	202310	BOLT - MACHINE HEX HD.
-	6	202510	BOLT - MACHINE HEX HD.
-	14	212189	NUT - HEX. LOCK
-	2	214130	WASHER - HEL. SPRING LOCK
-	1	214280	WASHER - ST'D. FLAT

PART NUMBER: 002571

REVISION I.D. : A

DESCRIPTION: GLEANER R62, R65, R72, R75 SIEVE

<u>ITEM</u>	<u>QTY.</u>	<u>PART NUMBER</u>	<u>DESCRIPTION</u>
A	1	709181	REAR TUBE ASSY
B	1	709182	FRONT TUBE ASSY
C	1	709174	SIDE CHANNEL ASSY - LH
D	1	709175	SIDE CHANNEL ASSY RH
E	120	409000	AXLE CONNECTOR - FEMALE
F	120	409001	AXLE CONNECTOR - MALE
G	40	409002	CRANK ARM - LONG
H	80	409003	CRANK ARM - SHORT
I	40	409004	END CRANK - R.H.
J	40	409005	END CRANK - L.H.
K	7	212366	PUSHNUT - .250 STUD DIA.
L	1	222040	SNAP RING
M	1	709176	DIVIDER ASSEMBLY
N	2	709177	DIVIDER ASSEMBLY
O	1	709178	ADJUST. BAR ASSY
P	160	409221	CHAFFER SLAT
Q	-	-	-
R	-	-	-
-	16	202310	BOLT - MACHINE HEX HD.
-	16	212189	NUT - HEX. LOCK
-	1	214280	WASHER - ST'D. FLAT

PART NUMBER: 002572

REVISION I.D. : C

DESCRIPTION: GLEANER R62, R65, R72, R75 CHAFFER

<u>ITEM</u>	<u>QTY.</u>	<u>PART NUMBER</u>	<u>DESCRIPTION</u>
A	1	709180	REAR TUBE ASSY
B	1	709179	FRONT CHANNEL ASSY
C	1	709169	SIDE CHANNEL ASSY. - LH
D	1	709170	SIDE CHANNEL ASSY. - RH
E	132	409000	AXLE CONNECTOR - FEMALE
F	132	409001	AXLE CONNECTOR -MALE
G	33	409002	CRANK ARM - LONG
H	66	409003	CRANK ARM - SHORT
I	33	409004	END CRANK - R.H.
J	33	409005	END CRANK - L.H.
K	7	212366	PUSHNUT - .250 STUD DIA.
L	1	222040	SNAP RING
M	1	709167	DIVIDER ASSEMBLY
N	2	709168	DIVIDER ASSEMBLY
O	1	709171	ADJUST. BAR ASSY
P	128	409222	SLAT - GATEWAY LT
Q	4	409223	FLAT SLAT LT
R	-	-	-
-	2	202191	BOLT - HEX
-	8	202310	BOLT - MACHINE HEX HD.
-	6	202510	BOLT - MACHINE HEX HD.
-	14	212189	NUT - HEX. LOCK
-	2	214130	WASHER - HEL. SPRING LOCK
-	1	214280	WASHER - ST'D. FLAT

PART NUMBER: 002573

REVISION I.D. : B

DESCRIPTION: GLEANER R62, R65, R72, R75 CHAFFER

<u>ITEM</u>	<u>QTY.</u>	<u>PART NUMBER</u>	<u>DESCRIPTION</u>
A	1	709180	REAR TUBE ASSY
B	1	709179	FRONT CHANNEL ASSY
C	1	709161	SIDE CHANNEL ASSY. - LH
D	1	709162	SIDE CHANNEL ASSY. - RH
E	135	409000	AXLE CONNECTOR - FEMALE
F	135	409001	AXLE CONNECTOR -MALE
G	45	409002	CRANK ARM - LONG
H	90	409003	CRANK ARM - SHORT
I	45	409004	END CRANK - R.H.
J	45	409005	END CRANK - L.H.
K	7	212366	PUSHNUT - .250 STUD DIA.
L	1	222040	SNAP RING
M	1	709164	DIVIDER ASSEMBLY
N	2	709165	DIVIDER ASSEMBLY
O	1	709166	ADJUST. BAR ASSY
P	176	409222	SLAT - GATEWAY LT
Q	4	409220	FLAT SLAT ST
R	-	-	-
-	2	202191	BOLT - HEX
-	8	202310	BOLT - MACHINE HEX HD.
-	6	202510	BOLT - MACHINE HEX HD.
-	14	212189	NUT - HEX. LOCK
-	2	214130	WASHER - HEL. SPRING LOCK
-	1	214280	WASHER - ST'D. FLAT



SERVICE PART LIST

PART NUMBER: 002574

REVISION I.D. : B

DESCRIPTION: GLEANER R62, R65, R72, R75 SIEVE

<u>ITEM</u>	<u>QTY.</u>	<u>PART NUMBER</u>	<u>DESCRIPTION</u>
A	1	709181	REAR TUBE ASSY
B	1	709182	FRONT TUBE ASSY
C	1	709174	SIDE CHANNEL ASSY - LH
D	1	709175	SIDE CHANNEL ASSY RH
E	120	409000	AXLE CONNECTOR - FEMALE
F	120	409001	AXLE CONNECTOR - MALE
G	40	409002	CRANK ARM - LONG
H	80	409003	CRANK ARM - SHORT
I	40	409004	END CRANK - R.H.
J	40	409005	END CRANK - L.H.
K	7	212366	PUSHNUT - .250 STUD DIA.
L	1	222040	SNAP RING
M	1	709176	DIVIDER ASSEMBLY
N	2	709177	DIVIDER ASSEMBLY
O	1	709178	ADJUST. BAR ASSY
P	156	409224	SLAT - GATEWAY LT
Q	4	409221	CHAFFER SLAT
R	-	-	-
-	16	202310	BOLT - MACHINE HEX HD.
-	16	212189	NUT - HEX. LOCK
-	1	214280	WASHER - ST'D. FLAT

PART NUMBER: 002580

REVISION I.D. : B

DESCRIPTION: MASSEY 9790 CHAFFER

<u>ITEM</u>	<u>QTY.</u>	<u>PART NUMBER</u>	<u>DESCRIPTION</u>
A	1	709128	REAR TUBE ASSY
B	1	709129	FRONT TUBE ASSEMBLY
C	1	709130	SIDE CHANNEL ASSY LH
D	1	709131	SIDE CHANNEL ASSY RH
E	168	409000	AXLE CONNECTOR- FEMALE
F	168	409001	AXLE CONNECTOR - MALE
G	56	409002	CRANK ARM - LONG
H	112	409003	CRANK ARM - SHORT
I	56	409004	END CRANK - R.H.
J	56	409005	END CRANK - L.H.
K	10	212366	PUSHNUT - .250 STUD DIA.
L	1	222040	SNAP RING
M	1	709132	DIVIDER ASSEMBLY
N	2	709133	DIVIDER ASSEMBLY
O	1	709134	ADJUST. BAR ASSY
P	220	409192	CHAFFER SLAT - ST
Q	4	409257	FLAT SLAT ST
R	-	-	-
-	2	202191	BOLT - HEX
-	14	202200	BOLT - MACHINE HEX HD.
-	14	212189	NUT - HEX. LOCK
-	2	214130	WASHER - HEL. SPRING LOCK
-	1	214280	WASHER - ST'D. FLAT
-	4	409457	FILLER PIECE

PART NUMBER: 002581

REVISION I.D. : C

DESCRIPTION: MASSEY 9790 SIEVE

<u>ITEM</u>	<u>QTY.</u>	<u>PART NUMBER</u>	<u>DESCRIPTION</u>
A	1	709211	REAR TUBE ASSEMBLY
B	1	709208	FRONT TUBE ASSEMBLY
C	1	709209	SIDE CHANNEL ASSY. - LH
D	1	709210	SIDE CHANNEL ASSY. - RH
E	138	409000	AXLE CONNECTOR- FEMALE
F	138	409001	AXLE CONNECTOR - MALE
G	46	409002	CRANK ARM - LONG
H	92	409003	CRANK ARM - SHORT
I	46	409004	END CRANK - R.H.
J	46	409005	END CRANK - L.H.
K	9	212366	PUSHNUT - .250 STUD DIA.
L	1	222040	SNAP RING
M	1	709139	DIVIDER ASSEMBLY
N	2	709140	DIVIDER ASSEMBLY
O	1	709006	ADJUSTMENT BAR ASSY.
P	184	409299	SIEVE SLAT - ST
Q	4	409457	FILLER PIECE
R	-	-	-
-	2	202191	BOLT - HEX
-	14	202200	BOLT - MACHINE HEX HD.
-	14	212189	NUT - HEX. LOCK
-	2	214130	WASHER - HEL. SPRING LOCK
-	1	214280	WASHER - ST'D. FLAT

PART NUMBER: 002582

REVISION I.D. : B

DESCRIPTION: MASSEY 9790 CHAFFER

<u>ITEM</u>	<u>QTY.</u>	<u>PART NUMBER</u>	<u>DESCRIPTION</u>
A	1	709128	REAR TUBE ASSY
B	1	709129	FRONT TUBE ASSEMBLY
C	1	709143	SIDE CHANNEL ASSY LH
D	1	709144	SIDE CHANNEL ASSY RH
E	123	409000	AXLE CONNECTOR- FEMALE
F	123	409001	AXLE CONNECTOR - MALE
G	41	409002	CRANK ARM - LONG
H	82	409003	CRANK ARM - SHORT
I	41	409004	END CRANK - R.H.
J	41	409005	END CRANK - L.H.
K	9	212366	PUSHNUT - .250 STUD DIA.
L	1	222040	SNAP RING
M	1	709142	DIVIDER ASSEMBLY
N	2	709150	DIVIDER ASSEMBLY
O	1	709145	ADJUST. BAR ASSY
P	156	409193	SIEVE SLAT - LT
Q	-	-	-
R	8	409258	FLAT SLAT - LT
-	2	202191	BOLT - HEX
-	14	202200	BOLT - MACHINE HEX HD.
-	14	212189	NUT - HEX. LOCK
-	2	214130	WASHER - HEL. SPRING LOCK
-	1	214280	WASHER - ST'D. FLAT
-	4	409457	FILLER PIECE



SERVICE PART LIST

PART NUMBER: 002583

REVISION I.D. : B

DESCRIPTION: MASSEY 9790 CHAFFER

ITEM	QTY.	PART NUMBER	DESCRIPTION
A	1	709128	REAR TUBE ASSY
B	1	709129	FRONT TUBE ASSEMBLY
C	1	709130	SIDE CHANNEL ASSY LH
D	1	709131	SIDE CHANNEL ASSY RH
E	168	409000	AXLE CONNECTOR- FEMALE
F	168	409001	AXLE CONNECTOR - MALE
G	56	409002	CRANK ARM - LONG
H	112	409003	CRANK ARM - SHORT
I	56	409004	END CRANK - R.H.
J	56	409005	END CRANK - L.H.
K	10	212366	PUSHNUT - .250 STUD DIA.
L	1	222040	SNAP RING
M	1	709132	DIVIDER ASSEMBLY
N	2	709133	DIVIDER ASSEMBLY
O	1	709134	ADJUST. BAR ASSY
P	220	409193	SIEVE SLAT - LT
Q	4	409257	FLAT SLAT ST
R	-	-	-
-	2	202191	BOLT - HEX
-	14	202200	BOLT - MACHINE HEX HD.
-	14	212189	NUT - HEX. LOCK
-	2	214130	WASHER - HEL. SPRING LOCK
-	1	214280	WASHER - ST'D. FLAT
-	4	409457	FILLER PIECE

PART NUMBER: 002626

REVISION I.D. : A

DESCRIPTION: CNH CR920, CR940, CR960 SIEVE

ITEM	QTY.	PART NUMBER	DESCRIPTION
A	1	709187	REAR TUBE ASSY
B	1	709184	FRONT CHANNEL ASSY
C	1	709120	SIDE CHANNEL ASSY LH
D	1	709121	SIDE CHANNEL ASSY RH
E	120	409000	AXLE CONNECTOR- FEMALE
F	120	409001	AXLE CONNECTOR - MALE
G	7	409002	CRANK ARM - LONG
H	80	409003	CRANK ARM - SHORT
I	40	409004	END CRANK - R.H.
J	40	409005	END CRANK - L.H.
K	7	212366	PUSHNUT - .250 STUD DIA.
L	1	222040	SNAP RING
M	1	709117	DIVIDER ASSEMBLY
N	2	709185	DIVIDER ASSEMBLY
O	1	709122	ADJUST. BAR ASSY
P	160	409244	SLAT
Q	-	-	-
R	-	-	-
-	3	202570	HBOLT 0.3750-16x2.75x1-N
-	4	206070	CAP SCREW - FLAT HD. HX. SOC
-	9	212189	NUT - HEX. LOCK
-	4	212411	LOCKNUT M8-1.25
-	1	214280	WASHER - ST'D. FLAT
-	6	202310	BOLT - MACHINE HEX HD.

PART NUMBER: 002584

REVISION I.D. : C

DESCRIPTION: MASSEY 9790 SIEVE

ITEM	QTY.	PART NUMBER	DESCRIPTION
A	1	709211	REAR TUBE ASSEMBLY
B	1	709208	FRONT TUBE ASSEMBLY
C	1	709209	SIDE CHANNEL ASSY. - LH
D	1	709210	SIDE CHANNEL ASSY. - RH
E	138	409000	AXLE CONNECTOR- FEMALE
F	138	409001	AXLE CONNECTOR - MALE
G	46	409002	CRANK ARM - LONG
H	92	409003	CRANK ARM - SHORT
I	46	409004	END CRANK - R.H.
J	46	409005	END CRANK - L.H.
K	9	212366	PUSHNUT - .250 STUD DIA.
L	1	222040	SNAP RING
M	1	709139	DIVIDER ASSEMBLY
N	2	709140	DIVIDER ASSEMBLY
O	1	709006	ADJUSTMENT BAR ASSY.
P	180	409300	CHAFFER SLAT - LT
Q	4	409299	SIEVE SLAT - ST
R	-	-	-
-	2	202191	BOLT - HEX
-	14	202200	BOLT - MACHINE HEX HD.
-	14	212189	NUT - HEX. LOCK
-	2	214130	WASHER - HEL. SPRING LOCK
-	1	214280	WASHER - ST'D. FLAT
-	4	409457	FILLER PIECE

PART NUMBER: 002627

REVISION I.D. : A

DESCRIPTION: CNH CR920, CR940, CR960 CHAFFER

ITEM	QTY.	PART NUMBER	DESCRIPTION
A	1	709183	REAR TUBE ASSY
B	1	709184	FRONT CHANNEL ASSY
C	1	709125	SIDE CHANNEL ASSY LH
D	1	709126	SIDE CHANNEL ASSY RH
E	90	409000	AXLE CONNECTOR- FEMALE
F	90	409001	AXLE CONNECTOR - MALE
G	30	409002	CRANK ARM - LONG
H	60	409003	CRANK ARM - SHORT
I	30	409004	END CRANK - R.H.
J	30	409005	END CRANK - L.H.
K	7	212366	PUSHNUT - .250 STUD DIA.
L	1	222040	SNAP RING
M	1	709124	DIVIDER ASSEMBLY
M	2	709188	DIVIDER ASSEMBLY
O	1	709127	ADJUST. BAR ASSY
P	112	409245	SLAT - GATEWAY LT
Q	4	409246	FLAT SLAT - ST
R	4	409249	FLAT SLAT - LT
-	6	202310	BOLT - MACHINE HEX HD.
-	3	202570	HBOLT 0.3750-16x2.75x1-N
-	4	206070	CAP SCREW - FLAT HD. HX. SOC
-	9	212189	NUT - HEX. LOCK
-	4	212411	LOCKNUT M8-1.25
-	1	214280	WASHER - ST'D. FLAT



SERVICE PART LIST

PART NUMBER: 002629

REVISION I.D. : **A**

DESCRIPTION: CNH CR920, CR940, CR960 SIEVE

ITEM	QTY.	PART NUMBER	DESCRIPTION
A	1	709187	REAR TUBE ASSY
B	1	709184	FRONT CHANNEL ASSY
C	1	709120	SIDE CHANNEL ASSY LH
D	1	709121	SIDE CHANNEL ASSY RH
E	120	409000	AXLE CONNECTOR- FEMALE
F	120	409001	AXLE CONNECTOR - MALE
G	40	409002	CRANK ARM - LONG
H	80	409003	CRANK ARM - SHORT
I	40	409004	END CRANK - R.H.
J	40	409005	END CRANK - L.H.
K	7	212366	PUSHNUT - .250 STUD DIA.
L	1	222040	SNAP RING
M	1	709117	DIVIDER ASSEMBLY
N	2	709185	DIVIDER ASSEMBLY
O	1	709122	ADJUST. BAR ASSY
P	156	409245	SLAT - GATEWAY LT
Q	4	409244	SLAT
R	-	-	-
-	6	202310	BOLT - MACHINE HEX HD.
-	3	202570	HBOLT 0.3750-16x2.75x1-N
-	4	206070	CAP SCREW - FLAT HD. HX. SOC
-	9	212189	NUT - HEX. LOCK
-	4	212411	LOCKNUT M8-1.25
-	1	214280	WASHER - ST'D. FLAT

PART NUMBER: 002631

REVISION I.D. : **B**

DESCRIPTION: NEW HOLLAND TR 96 SIEVE

ITEM	QTY.	PART NUMBER	DESCRIPTION
A	1	709073	REAR CHANNEL ASSY
B	1	409120	CHANNEL - FRONT
C	1	709079	SIDE CHANNEL ASSY - LH
D	1	709080	SIDE CHANNEL ASSY - RH
E	99	409000	AXLE CONNECTOR- FEMALE
F	99	409001	AXLE CONNECTOR - MALE
G	33	409002	CRANK ARM - LONG
H	66	409003	CRANK ARM - SHORT
I	33	409004	END CRANK - R.H.
J	33	409005	END CRANK - L.H.
K	6	212366	PUSHNUT - .250 STUD DIA.
L	1	222040	SNAP RING
M	1	709081	DIVIDER ASSY
N	2	709082	DIVIDER ASSY
O	1	709083	ADJUSTMENT BAR ASSY.
P	132	409118	CHAFFER SLAT
Q	-	-	-
R	-	-	-
-	16	202130	BOLT - MACHINE HEX. HD.
-	16	212189	NUT - HEX. LOCK
-	1	214280	WASHER - ST'D. FLAT
-	4	409457	FILLER PIECE

PART NUMBER: 002634

REVISION I.D. : **B**

DESCRIPTION: NEW HOLLAND TR 96 SIEVE

ITEM	QTY.	PART NUMBER	DESCRIPTION
A	1	709073	REAR CHANNEL ASSY
B	1	409120	CHANNEL - FRONT
C	1	709079	SIDE CHANNEL ASSY - LH
D	1	709080	SIDE CHANNEL ASSY - RH
E	99	409000	AXLE CONNECTOR - FEMALE
F	99	409001	AXLE CONNECTOR - MALE
G	33	409002	CRANK ARM - LONG
H	66	409003	CRANK ARM - SHORT
I	33	409004	END CRANK - R.H.
J	33	409005	END CRANK - L.H.
K	7	212366	PUSHNUT - .250 STUD DIA.
L	1	222040	SNAP RING
M	1	709081	DIVIDER ASSY
N	2	709082	DIVIDER ASSY
O	1	709083	ADJUSTMENT BAR ASSY.
P	128	409119	GATEWAY SLAT LT
Q	4	409118	CHAFFER SLAT
R	-	-	-
-	16	202130	BOLT - MACHINE HEX. HD.
-	16	212189	NUT - HEX. LOCK
-	1	214280	WASHER - ST'D. FLAT
-	4	409457	FILLER PIECE

PART NUMBER: 002635

REVISION I.D. : **B**

DESCRIPTION: NEW HOLLAND TR 96 EXTENSION

ITEM	QTY.	PART NUMBER	DESCRIPTION
A	1	709089	REAR CHANNEL ASSY
B	1	709093	FRONT CHANNEL ASSY
C	1	709090	SIDE CHANNEL ASSY LH
D	1	709091	SIDE CHANNEL ASSY RH
E	27	409000	AXLE CONNECTOR FEMALE
F	27	409001	AXLE CONNECTOR MALE
G	9	409002	CRANK ARM - LONG
H	18	409003	CRANK ARM - SHORT
I	9	409004	END CRANK - R.H.
J	9	409005	END CRANK - L.H.
K	3	212366	PUSHNUT - .250 STUD DIA.
L	1	222040	SNAP RING
M	1	709094	DIVIDER ASSY
N	2	709095	DIVIDER ASSY
O	1	709092	ADJUSTMENT BAR ASSY.
P	32	409119	GATEWAY SLAT LT
Q	4	409139	GATEWAY FLAT SLAT ST
R	-	-	-
-	16	202130	BOLT - MACHINE HEX. HD.
-	16	212189	NUT - HEX. LOCK
-	1	214280	WASHER - ST'D. FLAT
-	4	405700	FILLER PIECE



SERVICE PART LIST

PART NUMBER: 002656

REVISION I.D. : **B**

DESCRIPTION: JOHN DEERE 8820 SIEVE

S/N 610700 AND PRIOR

<u>ITEM</u>	<u>QTY.</u>	<u>PART NUMBER</u>	<u>DESCRIPTION</u>
A	1	709377	REAR TUBE ASSEMBLY
B	1	709376	FRONT TUBE ASSEMBLY
C	1	709378	SIDE CHANNEL ASSY - LH
D	1	709379	SIDE CHANNEL ASSY - RH
E	96	409000	AXLE CONNECTOR
F	96	409001	AXLE CONNECTOR
G	32	409002	CRANK ARM - LONG
H	64	409003	CRANK ARM - SHORT
I	32	409004	END CRANK - R.H.
J	32	409005	END CRANK - L.H.
K	6	212366	PUSHNUT - .250 STUD DIA.
L	1	222040	SNAP RING
M	1	709380	DIVIDER ASSEMBLY
N	2	709381	DIVIDER ASSEMBLY
O	1	709382	ADJUSTMENT BAR ASSY.
P	128	409561	SIEVE SLAT
Q	-	-	-
R	-	-	-
-	16	202510	BOLT - MACHINE HEX HD.
-	16	212189	NUT - HEX. LOCK
-	1	214280	WASHER - ST'D. FLAT
-	4	409250	FILLER PIECE

PART NUMBER: 002659

REVISION I.D. : **A**

DESCRIPTION: JOHN DEERE 8820 SIEVE

S/N 610700 AND PRIOR

<u>ITEM</u>	<u>QTY.</u>	<u>PART NUMBER</u>	<u>DESCRIPTION</u>
A	1	709377	REAR TUBE ASSEMBLY
B	1	709376	FRONT TUBE ASSEMBLY
C	1	709378	SIDE CHANNEL ASSY - LH
D	1	709379	SIDE CHANNEL ASSY - RH
E	96	409000	AXLE CONNECTOR - FEMALE
F	96	409001	AXLE CONNECTOR - MALE
G	32	409002	CRANK ARM - LONG
H	64	409003	CRANK ARM - SHORT
I	32	409004	END CRANK - R.H.
J	32	409005	END CRANK - L.H.
K	6	212366	PUSHNUT - .250 STUD DIA.
L	1	222040	SNAP RING
M	1	709380	DIVIDER ASSEMBLY
N	2	709381	DIVIDER ASSEMBLY
O	1	709382	ADJUSTMENT BAR ASSY.
P	128	409536	SLAT - GATEWAY LT
Q	4	409561	SIEVE SLAT
R	-	-	-
-	16	202510	BOLT - MACHINE HEX HD.
-	16	212189	NUT - HEX. LOCK
-	1	214280	WASHER - ST'D. FLAT

PART NUMBER: 002661

REVISION I.D. : **A**

DESCRIPTION: JOHN DEERE 7700, 7701, 7720, 7721 SIEVE

PRIOR TO S/N 610500

<u>ITEM</u>	<u>QTY.</u>	<u>PART NUMBER</u>	<u>DESCRIPTION</u>
A	1	709452	REAR TUBE ASSEMBLY
B	1	709451	FRONT TUBE ASSEMBLY
C	1	709378	SIDE CHANNEL ASSY - LH
D	1	709379	SIDE CHANNEL ASSY - RH
E	96	409000	AXLE CONNECTOR
F	96	409001	AXLE CONNECTOR
G	32	409002	CRANK ARM - LONG
H	64	409003	CRANK ARM - SHORT
I	32	409004	END CRANK - R.H.
J	32	409005	END CRANK - L.H.
K	6	212366	PUSHNUT - .250 STUD DIA.
L	1	222040	SNAP RING
M	1	709380	DIVIDER ASSEMBLY
N	2	709381	DIVIDER ASSEMBLY
O	1	709382	ADJUSTMENT BAR ASSY.
P	128	409628	SIEVE SLAT
Q	-	-	-
R	-	-	-
-	16	202510	BOLT - MACHINE HEX HD.
-	16	212189	NUT - HEX. LOCK
-	1	214280	WASHER - ST'D. FLAT
-	4	405700	FILLER PIECE

PART NUMBER: 002664

REVISION I.D. : **A**

DESCRIPTION: JOHN DEERE 7700, 7701, 7720, 7721 SIEVE

PRIOR TO S/N 610500

<u>ITEM</u>	<u>QTY.</u>	<u>PART NUMBER</u>	<u>DESCRIPTION</u>
A	1	709452	REAR TUBE ASSEMBLY
B	1	709451	FRONT TUBE ASSEMBLY
C	1	709378	SIDE CHANNEL ASSY - LH
D	1	709379	SIDE CHANNEL ASSY - RH
E	96	409000	AXLE CONNECTOR
F	96	409001	AXLE CONNECTOR
G	32	409002	CRANK ARM - LONG
H	64	409003	CRANK ARM - SHORT
I	32	409004	END CRANK - R.H.
J	32	409005	END CRANK - L.H.
K	6	212366	PUSHNUT - .250 STUD DIA.
L	1	222040	SNAP RING
M	1	709380	DIVIDER ASSEMBLY
N	2	709381	DIVIDER ASSEMBLY
O	1	709382	ADJUSTMENT BAR ASSY.
P	124	409630	SLAT - GATEWAY LT
Q	4	409628	SIEVE SLAT
R	-	-	-
-	16	202510	BOLT - MACHINE HEX HD.
-	16	212189	NUT - HEX. LOCK
-	1	214280	WASHER - ST'D. FLAT
-	4	405700	FILLER PIECE



SERVICE PART LIST

PART NUMBER: 002671

REVISION I.D. : **A**

DESCRIPTION: JOHN DEERE 8820 TITAN II SIEVE

ITEM	QTY.	PART NUMBER	DESCRIPTION
A	1	709391	REAR TUBE ASSEMBLY
B	1	709392	FRONT TUBE ASSEMBLY
C	1	709386	SIDE CHANNEL ASSY - LH
D	1	709387	SIDE CHANNEL ASSY - RH
E	108	409000	AXLE CONNECTOR - FEMALE
F	108	409001	AXLE CONNECTOR - MALE
G	36	409002	CRANK ARM - LONG
H	72	409003	CRANK ARM - SHORT
I	36	409004	END CRANK - R.H.
J	36	409005	END CRANK - L.H.
K	6	212366	PUSHNUT - .250 STUD DIA.
L	1	222040	SNAP RING
M	1	709388	DIVIDER ASSEMBLY
N	2	709389	DIVIDER ASSEMBLY
O	1	709390	ADJUSTMENT BAR ASSY.
P	140	409561	SIEVE SLAT
Q	4	409211	FLAT SLAT ST
R	-	-	-
-	16	202670	BOLT - MACHINE HEX HD.
-	16	212189	NUT - HEX. LOCK
-	1	214280	WASHER - ST'D. FLAT

PART NUMBER: 002674

REVISION I.D. : **A**

DESCRIPTION: JOHN DEERE 8820 TITAN II SIEVE

ITEM	QTY.	PART NUMBER	DESCRIPTION
A	1	709391	REAR TUBE ASSEMBLY
B	1	709392	FRONT TUBE ASSEMBLY
C	1	709386	SIDE CHANNEL ASSY - LH
D	1	709387	SIDE CHANNEL ASSY - RH
E	108	409000	AXLE CONNECTOR - FEMALE
F	108	409001	AXLE CONNECTOR - MALE
G	36	409002	CRANK ARM - LONG
H	72	409003	CRANK ARM - SHORT
I	36	409004	END CRANK - R.H.
J	36	409005	END CRANK - L.H.
K	6	212366	PUSHNUT - .250 STUD DIA.
L	1	222040	SNAP RING
M	1	709388	DIVIDER ASSEMBLY
N	2	709389	DIVIDER ASSEMBLY
O	1	709390	ADJUSTMENT BAR ASSY.
P	140	409536	SLAT - GATEWAY LT
Q	4	409561	SIEVE SLAT
R	-	-	-
-	16	202670	BOLT - MACHINE HEX HD.
-	16	212189	NUT - HEX. LOCK
-	1	214280	WASHER - ST'D. FLAT

PART NUMBER: 002676

REVISION I.D. : **B**

DESCRIPTION: JOHN DEERE 7720 TITAN II SIEVE

ITEM	QTY.	PART NUMBER	DESCRIPTION
A	1	709453	REAR TUBE ASSEMBLY
B	1	709454	FRONT TUBE ASSEMBLY
C	1	709455	SIDE CHANNEL ASSY - LH
D	1	709456	SIDE CHANNEL ASSY - RH
E	108	409000	AXLE CONNECTOR
F	108	409001	AXLE CONNECTOR
G	36	409002	CRANK ARM - LONG
H	72	409003	CRANK ARM - SHORT
I	36	409004	END CRANK - R.H.
J	36	409005	END CRANK - L.H.
K	6	212366	PUSHNUT - .250 STUD DIA.
L	1	222040	SNAP RING
M	1	709457	DIVIDER ASSEMBLY
N	2	709458	DIVIDER ASSEMBLY
O	1	709390	ADJUSTMENT BAR ASSY.
P	144	409628	SIEVE SLAT
Q	-	-	-
R	-	-	-
-	16	202510	BOLT - MACHINE HEX HD.
-	16	212189	NUT - HEX. LOCK
-	1	214280	WASHER - ST'D. FLAT
-	4	405700	FILLER PIECE

PART NUMBER: 002679

REVISION I.D. : **B**

DESCRIPTION: JOHN DEERE 7720 TITAN II SIEVE

ITEM	QTY.	PART NUMBER	DESCRIPTION
A	1	709453	REAR TUBE ASSEMBLY
B	1	709454	FRONT TUBE ASSEMBLY
C	1	709455	SIDE CHANNEL ASSY - LH
D	1	709456	SIDE CHANNEL ASSY - RH
E	108	409000	AXLE CONNECTOR - FEMALE
F	108	409001	AXLE CONNECTOR - MALE
G	36	409002	CRANK ARM - LONG
H	72	409003	CRANK ARM - SHORT
I	36	409004	END CRANK - R.H.
J	36	409005	END CRANK - L.H.
K	6	212366	PUSHNUT - .250 STUD DIA.
L	1	222040	SNAP RING
M	1	709457	DIVIDER ASSEMBLY
N	2	709458	DIVIDER ASSEMBLY
O	1	709390	ADJUSTMENT BAR ASSY.
P	140	409630	SLAT - GATEWAY LT
Q	4	409628	SIEVE SLAT
P	-	-	-
-	16	202510	BOLT - MACHINE HEX HD.
-	16	212189	NUT - HEX. LOCK
-	1	214280	WASHER - ST'D. FLAT
-	4	409327	FILLER PIECE



SERVICE PART LIST

PART NUMBER: 002726

REVISION I.D. : A

DESCRIPTION: CNH E.A. NB 7010, CR, CX SIEVE

ITEM	QTY.	PART NUMBER	DESCRIPTION
A	1	709262	REAR TUBE ASSY
B	1	709184	FRONT CHANNEL ASSY
C	1	709120	SIDE CHANNEL ASSY LH
D	1	709121	SIDE CHANNEL ASSY RH
E	118	409000	AXLE CONNECTOR- FEMALE
F	118	409001	AXLE CONNECTOR - MALE
G	44	409002	CRANK ARM - LONG
H	72	409003	CRANK ARM - SHORT
I	42	409004	END CRANK - R.H.
J	42	409005	END CRANK - L.H.
K	8	212366	PUSHNUT - .250 STUD DIA.
L	-	-	-
M	1	709265	DIVIDER ASSEMBLY
N	2	709185	DIVIDER ASSEMBLY
O	1	409407	ADJUST. BAR
P	160	409244	SLAT
Q	-	-	-
R	-	-	-
S	1	709259	HANDLE ASSEMBLY
T	2	409414	ADJUST BAR (4 HOLE)
U	1	409420	RETAINER
V	1	409421	RETAINER

PART NUMBER: 002727

REVISION I.D. : A

DESCRIPTION: CNH E.A. NB 7010, CR, CX CHAFFER

ITEM	QTY.	PART NUMBER	DESCRIPTION
A	1	709261	REAR TUBE ASSY
B	1	709184	FRONT CHANNEL ASSY
C	1	709125	SIDE CHANNEL ASSY LH
D	1	709126	SIDE CHANNEL ASSY RH
E	90	409000	AXLE CONNECTOR- FEMALE
F	90	409001	AXLE CONNECTOR - MALE
G	30	409002	CRANK ARM - LONG
H	60	409003	CRANK ARM - SHORT
I	30	409004	END CRANK - R.H.
J	30	409005	END CRANK - L.H.
K	8	212366	PUSHNUT - .250 STUD DIA.
L	-	-	-
M	1	709266	DIVIDER ASSEMBLY
M	2	709188	DIVIDER ASSEMBLY
O	1	409413	ADJUST. BAR
P	112	409245	SLAT - GATEWAY LT
Q	4	409246	FLAT SLAT - ST
R	4	409249	FLAT SLAT - LT
S	1	709259	HANDLE ASSEMBLY
T	-	-	-

PART NUMBER: 002729

REVISION I.D. : A

DESCRIPTION: CNH E.A. NB 7010, CR, CX SIEVE

ITEM	QTY.	PART NUMBER	DESCRIPTION
A	1	709262	REAR TUBE ASSY
B	1	709184	FRONT CHANNEL ASSY
C	1	709120	SIDE CHANNEL ASSY LH
D	1	709121	SIDE CHANNEL ASSY RH
E	118	409000	AXLE CONNECTOR- FEMALE
F	118	409001	AXLE CONNECTOR - MALE
G	44	409002	CRANK ARM - LONG
H	72	409003	CRANK ARM - SHORT
I	42	409004	END CRANK - R.H.
J	42	409005	END CRANK - L.H.
K	8	212366	PUSHNUT - .250 STUD DIA.
L	-	-	-
M	1	709265	DIVIDER ASSEMBLY
N	2	709185	DIVIDER ASSEMBLY
O	1	409407	ADJUST. BAR
P	156	409245	SLAT-GATEWAY LT
Q	4	409244	SLAT
R	-	-	-
S	1	709259	HANDLE ASSEMBLY
T	2	409414	ADJUST BAR (4 HOLE)
U	1	409420	RETAINER
V	1	409421	RETAINER

PART NUMBER: 002728

REVISION I.D. : A

DESCRIPTION: CNH E.A. NB 7010, CR, CX CHAFFER

ITEM	QTY.	PART NUMBER	DESCRIPTION
A	1	709261	REAR TUBE ASSY
B	1	709184	FRONT CHANNEL ASSY
C	1	709120	SIDE CHANNEL ASSY LH
D	1	709121	SIDE CHANNEL ASSY RH
E	120	409000	AXLE CONNECTOR- FEMALE
F	120	409001	AXLE CONNECTOR - MALE
G	44	409002	CRANK ARM - LONG
H	72	409003	CRANK ARM - SHORT
I	42	409004	END CRANK - R.H.
J	42	409005	END CRANK - L.H.
K	8	212366	PUSHNUT - .250 STUD DIA.
L	-	-	-
M	1	709265	DIVIDER ASSEMBLY
M	2	709185	DIVIDER ASSEMBLY
O	1	409407	ADJUST. BAR
P	156	409245	SLAT - GATEWAY LT
Q	4	409246	FLAT SLAT - ST
R	-	-	-
S	1	709259	HANDLE ASSEMBLY
T	2	409414	ADJUST. BAR (4 HOLE)



SERVICE PART LIST

PART NUMBER: **002628**

REVISION I.D. : **A**

DESCRIPTION: CNH CR920, CR940, CR960 SIEVE

<u>ITEM</u>	<u>QTY.</u>	<u>PART NUMBER</u>	<u>DESCRIPTION</u>
A	1	709187	REAR TUBE ASSY
B	1	709184	FRONT CHANNEL ASSY
C	1	709120	SIDE CHANNEL ASSY LH
D	1	709121	SIDE CHANNEL ASSY RH
E	120	409000	AXLE CONNECTOR- FEMALE
F	120	409001	AXLE CONNECTOR - MALE
G	40	409002	CRANK ARM - LONG
H	80	409003	CRANK ARM - SHORT
I	40	409004	END CRANK - R.H.
J	40	409005	END CRANK - L.H.
K	9	212366	PUSHNUT - .250 STUD DIA.
L	2	222040	SNAP RING
M	2	709117	DIVIDER ASSEMBLY
N	1	709185	DIVIDER ASSEMBLY
O	1	709186	ADJUST. BAR ASSY
P	156	409245	SLAT - GATEWAY LT
Q	4	409244	SLAT
R	-	-	-
S	-	-	-
T	1	709122	ADJUST. BAR ASSY
-	6	202310	BOLT - MACHINE HEX HD.
-	3	202570	HBOLT 0.3750-16x2.75x1-N
-	4	206070	CAP SCREW - FLAT HD. HX. SOC
-	9	212189	NUT - HEX. LOCK



IF YOU HAVE OTHER QUESTIONS: Please contact your dealer or distributor.

You may also email or visit our website at:

e-mail: info@hccinc.com

web: www.hccinc.com

This manual is also available for download at: <http://www.hccinc.com/gateway-combine-sieves-and-combine-chaffers>

HCC, inc.
1501 1ST Avenue – Mendota, Illinois 61342
(815) 539-9371 Fax (815) 539-3135
WARRANTY REGISTRATION

Delivery Date _____ Ultimate User _____

Address _____

City, State (Province) _____ Zip/Postal Code _____

Country _____ Telephone (____) _____

Dealer/Distributor Name _____

Dealer/Distributor Customer Number _____ Telephone (____) _____

Address _____

City, State (Province) _____ Zip/Postal Code _____

Country _____

To be completed by DEALER / DISTRIBUTOR or ULTIMATE USER:

Please place an (X) in front of the product or products you are submitting this Warranty Registration form for.

- _____ Orbit Reel _____ Product kit number
- _____ Gateway Sieve or chaffer _____ Product frame number
- _____ Reel
- _____ Other / List _____

Please make a copy of this WARRANTY REGISTRATION form for your records and return the original to:

**Marketing & Sales Manager
HCC, Inc.
1501 1ST Avenue
Mendota, Illinois 61342 USA**

Form must be completed and returned to HCC, Inc. within 30 days from receipt of delivery or warranty may become void.

HCC, inc.
1501 1st Avenue – Mendota, Illinois 61342
(815) 539-9371 Fax (815) 539-3135
LIMITED WARRANTY

HCC, inc. warrants each new HCC, inc. product to be free from defects in material and workmanship. This warranty is applicable only for the normal service life expectancy of the product or components, not to exceed 12 consecutive months from the date of delivery of the new HCC, inc. product to the original purchaser.

Genuine HCC, inc. replacement parts and components will be warranted for 90 days from date of purchase, or the remainder of the original equipment warranty period, whichever is longer. There is no warranty for tires.

Under no circumstances will it cover any merchandise or components thereof, which, in the opinion of the company, has been subjected to misuse, unauthorized modifications, alteration, an accident, or if repairs have been made with parts other than those obtainable through HCC, inc.

Our obligation under this warranty shall be limited to repairing or replacing, free of charge to the original purchaser, any part that, in our judgment, shall show evidence of such defect, provided further that such part shall be returned within thirty (30) days from date of failure to HCC, inc., routed through the dealer and distributor from whom the purchase was made, transportation charges prepaid.

This warranty shall not be interpreted to render HCC, inc. liable for injury or damages of any kind or nature to person or property. This warranty does not extend to the loss of crops, loss because of delay in harvesting, or any expense or loss incurred for labor, substitute machinery, rental, or for any other reason.

Except as set forth above, **HCC, inc. shall have no obligation or liability of any kind on account of any of its equipment and shall not be liable for special or consequential damages. HCC, inc. makes no other warranty, expressed or implied, and specifically, HCC, inc. disclaims any implied warranty of merchantability or fitness for a particular purpose. Some states or provinces do not permit limitations or exclusions of implied warranties or incidental or consequential damages, so the limitations or exclusion in this warranty may not apply.**

This warranty is subject to any existing conditions of supply which may directly affect our ability to obtain materials or manufacture replacement parts.

HCC, inc. reserves the right to make improvements in design or changes in specifications at any time, without incurring any obligation to owners of units previously sold.

No one is authorized to alter, modify, or enlarge this warranty nor the exclusion, limitations, and reservations.

Effective with products delivered to original user on or after January 1, 2006