



# Gateway

SIEVE & CHAFFER SYSTEM

## *Parts Book*

Four Panel, Double Adjustment Frames

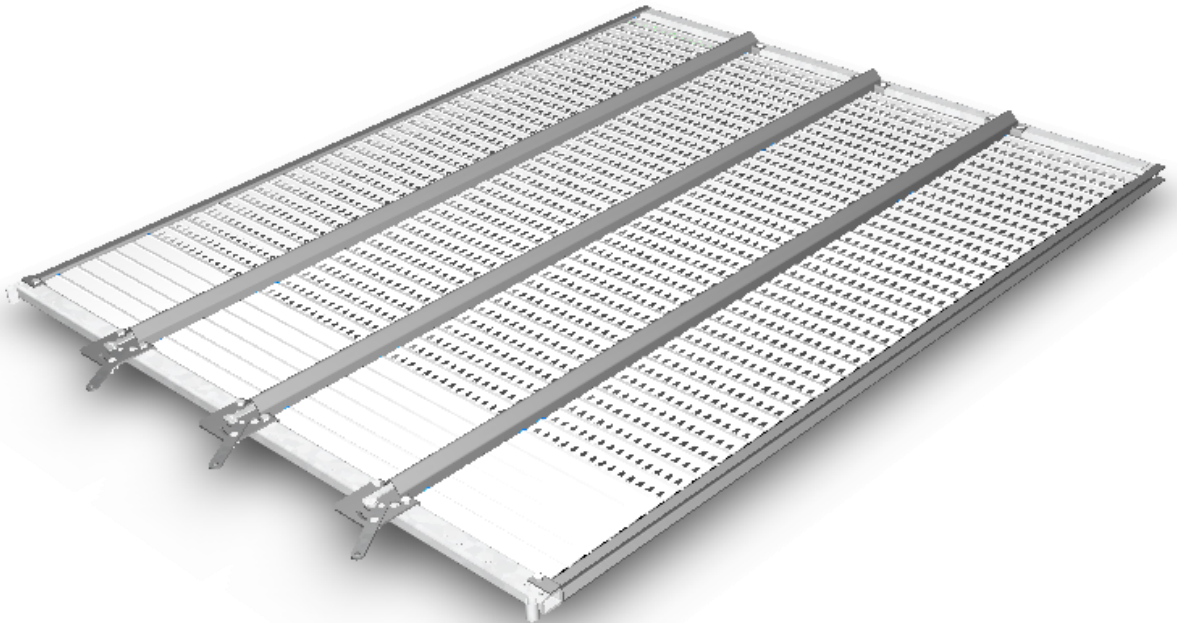

# **GATEWAY DIAGRAM**

The Gateway diagram on this page is generic, covering a wide variety of OEM equipment. A detailed parts list is available on the following page(s) for each specific sieve.

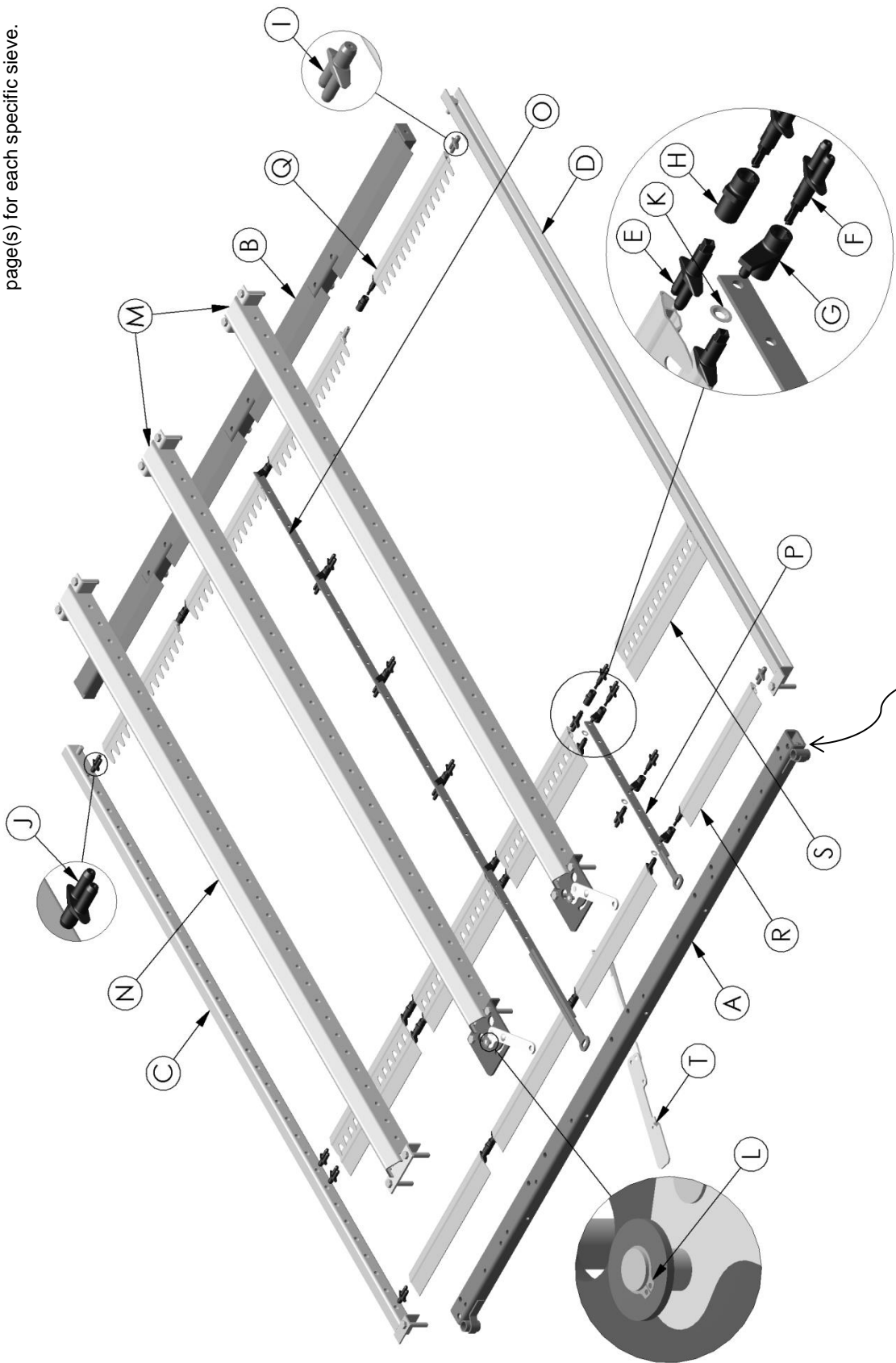



# SERVICE PART LIST

**PART NUMBER: 002625**

REVISION I.D. :-

DESCRIPTION: CNH CR920, CR940, CR960 CHAFFER

ITEM	QTY.	PART NUMBER	DESCRIPTION
A	1	709183	REAR TUBE ASSY
B	1	709184	FRONT CHANNEL ASSY
C	1	709120	SIDE CHANNEL ASSY LH
D	1	709121	SIDE CHANNEL ASSY RH
E	120	409000	AXLE CONNECTOR- FEMALE
F	120	409001	AXLE CONNECTOR - MALE
G	40	409002	CRANK ARM - LONG
H	80	409003	CRANK ARM - SHORT
I	40	409004	END CRANK - R.H.
J	40	409005	END CRANK - L.H.
K	9	212366	PUSHNUT - .250 STUD DIA.
L	2	222040	SNAP RING
M	2	709117	DIVIDER ASSEMBLY
N	1	709185	DIVIDER ASSEMBLY
O	1	709122	ADJUST. BAR ASSY
P	1	709186	ADJUST. BAR ASSY
Q	156	409244	SLAT
R	4	409246	FLAT SLAT - ST
S	-	-	-
-	6	202310	BOLT - MACHINE HEX HD.
-	3	202570	HBOLT 0.3750-16x2.75x1-N
-	4	206070	CAP SCREW - FLAT HD. HX. SOC
-	9	212189	NUT - HEX. LOCK
-	4	212411	LOCKNUT M8-1.25
-	2	214280	WASHER - ST'D. FLAT

**PART NUMBER: 002655**

REVISION I.D. : A

DESCRIPTION: JOHN DEERE 8820 CHAFFER  
S/N 610700 AND PRIOR

ITEM	QTY.	PART NUMBER	DESCRIPTION
A	1	709352	REAR TUBE ASSY
B	1	709351	FRONT TUBE ASSEMBLY
C	1	709353	SIDE CHANNEL ASSY. - LH
D	1	709354	SIDE CHANNEL ASSY. - RH
E	129	409000	AXLE CONNECTOR - FEMALE
F	129	409001	AXLE CONNECTOR - MALE
G	43	409002	CRANK ARM - LONG
H	86	409003	CRANK ARM - SHORT
I	43	409004	END CRANK - R.H.
J	43	409005	END CRANK - L.H.
K	9	212366	PUSHNUT - .250 STUD DIA.
L	2	222040	SNAP RING
M	2	709355	DIVIDER ASSEMBLY
N	1	709356	DIVIDER ASSEMBLY
O	1	709357	ADJUST. BAR ASSY - MIDDLE
P	1	709358	ADJUST. BAR ASSY - REAR
Q	168	409535	SLAT
R	4	409205	FLAT SLAT ST
S	-	-	-
-	2	202191	BOLT - HEX
-	6	202200	BOLT - MACHINE HEX HD.
-	10	202670	BOLT - MACHINE HEX HD.
-	16	212189	NUT - HEX. LOCK
-	2	214130	WASHER - HEL. SPRING LOCK
-	2	214280	WASHER - ST'D. FLAT

**PART NUMBER: 002628**

REVISION I.D. :-

DESCRIPTION: CNH CR920, CR940, CR960 CHAFFER

ITEM	QTY.	PART NUMBER	DESCRIPTION
A	1	709183	REAR TUBE ASSY
B	1	709184	FRONT CHANNEL ASSY
C	1	709120	SIDE CHANNEL ASSY LH
D	1	709121	SIDE CHANNEL ASSY RH
E	120	409000	AXLE CONNECTOR - FEMALE
F	120	409001	AXLE CONNECTOR - MALE
G	40	409002	CRANK ARM - LONG
H	80	409003	CRANK ARM - SHORT
I	40	409004	END CRANK - R.H.
J	40	409005	END CRANK - L.H.
K	9	212366	PUSHNUT - .250 STUD DIA.
L	2	222040	SNAP RING
M	2	709117	DIVIDER ASSEMBLY
N	1	709185	DIVIDER ASSEMBLY
O	1	709122	ADJUST. BAR ASSY
P	1	709186	ADJUST. BAR ASSY
Q	156	409245	SLAT - GATEWAY LT
R	4	409246	FLAT SLAT - ST
S	-	-	-
-	6	202310	BOLT - MACHINE HEX HD.
-	3	202570	HBOLT 0.3750-16x2.75x1-N
-	4	206070	CAP SCREW - FLAT HD. HX. SOC
-	9	212189	NUT - HEX. LOCK
-	4	212411	LOCKNUT M8-1.25
-	2	214280	WASHER - ST'D. FLAT

**PART NUMBER: 002657**

REVISION I.D. : A

DESCRIPTION: JOHN DEERE 8820 CHAFFER  
S/N 610700 AND PRIOR

ITEM	QTY.	PART NUMBER	DESCRIPTION
A	1	709352	REAR TUBE ASSY
B	1	709351	FRONT TUBE ASSEMBLY
C	1	709402	SIDE CHANNEL ASSY. - LH
D	1	709404	SIDE CHANNEL ASSY. - RH
E	96	409000	AXLE CONNECTOR
F	96	409001	AXLE CONNECTOR
G	32	409002	CRANK ARM - LONG
H	64	409003	CRANK ARM - SHORT
I	32	409004	END CRANK - R.H.
J	32	409005	END CRANK - L.H.
K	10	212366	PUSHNUT - .250 STUD DIA.
L	2	222040	SNAP RING
M	2	709401	DIVIDER ASSEMBLY
N	1	709403	DIVIDER ASSEMBLY
O	1	709405	ADJUST. BAR ASSY - MIDDLE
P	1	709406	ADJUST. BAR ASSY - REAR
Q	120	409579	SLAT - GATEWAY LT
R	4	409205	FLAT SLAT ST
S	4	409206	FLAT SLAT LT
-	2	202191	BOLT - HEX
-	6	202200	BOLT - MACHINE HEX HD.
-	10	202670	BOLT - MACHINE HEX HD.
-	16	212189	NUT - HEX. LOCK
-	2	214130	WASHER - HEL. SPRING LOCK
-	2	214280	WASHER - STD. FLAT



# SERVICE PART LIST

**PART NUMBER: 002658**

REVISION I.D. : **A**

DESCRIPTION: JOHN DEERE 8820 CHAFFER  
S/N 610700 AND PRIOR

ITEM	QTY.	PART NUMBER	DESCRIPTION
A	1	709352	REAR TUBE ASSY
B	1	709351	FRONT TUBE ASSEMBLY
C	1	709353	SIDE CHANNEL ASSY. - LH
D	1	709354	SIDE CHANNEL ASSY. - RH
E	129	409000	AXLE CONNECTOR - FEMALE
F	129	409001	AXLE CONNECTOR - MALE
G	43	409002	CRANK ARM - LONG
H	86	409003	CRANK ARM - SHORT
I	43	409004	END CRANK - R.H.
J	43	409005	END CRANK - L.H.
K	9	212366	PUSHNUT - .250 STUD DIA.
L	2	222040	SNAP RING
M	2	709355	DIVIDER ASSEMBLY
N	1	709356	DIVIDER ASSEMBLY
O	1	709357	ADJUST. BAR ASSY - MIDDLE
P	1	709358	ADJUST. BAR ASSY - REAR
Q	168	409579	SLAT - GATEWAY LT
R	4	409205	FLAT SLAT ST
S	-	-	-
-	2	202191	BOLT - HEX
-	6	202200	BOLT - MACHINE HEX HD.
-	10	202670	BOLT - MACHINE HEX HD.
-	16	212189	NUT - HEX. LOCK
-	2	214130	WASHER - HEL. SPRING LOCK
-	2	214280	WASHER - ST'D. FLAT

**PART NUMBER: 002660**

REVISION I.D. : -

DESCRIPTION: JOHN DEERE 7700,7701 , 7720, 7721 CHAFFER  
PRIOR TO S/N 610500

ITEM	QTY.	PART NUMBER	DESCRIPTION
A	1	409602	REAR TUBE
B	1	709426	FRONT TUBE ASSEMBLY
C	1	709353	SIDE CHANNEL ASSY. - LH
D	1	709354	SIDE CHANNEL ASSY. - RH
E	129	409000	AXLE CONNECTOR - FEMALE
F	129	409001	AXLE CONNECTOR - MALE
G	43	409002	CRANK ARM - LONG
H	86	409003	CRANK ARM - SHORT
I	43	409004	END CRANK - R.H.
J	43	409005	END CRANK - L.H.
K	9	212366	PUSHNUT - .250 STUD DIA.
L	2	222040	SNAP RING
M	2	709355	DIVIDER ASSEMBLY
N	1	709356	DIVIDER ASSEMBLY
O	1	709357	ADJUST. BAR ASSY - MIDDLE
P	1	709358	ADJUST. BAR ASSY - REAR
Q	168	409609	CHAFFER SLAT
R	4	409207	FLAT SLAT ST
S	-	-	-
-	2	202191	BOLT - HEX
-	6	202200	BOLT - MACHINE HEX HD.
-	10	202510	BOLT - MACHINE HEX HD.
-	16	212189	NUT - HEX. LOCK
-	2	214130	WASHER - HEL. SPRING LOCK
-	2	214280	WASHER - ST'D. FLAT

**PART NUMBER: 002662**

REVISION I.D. : -

DESCRIPTION: JOHN DEERE 7700,7701 , 7720, 7721 CHAFFER  
PRIOR TO S/N 610500

ITEM	QTY.	PART NUMBER	DESCRIPTION
A	1	409602	REAR TUBE
B	1	709426	FRONT TUBE ASSEMBLY
C	1	709402	SIDE CHANNEL ASSY. - LH
D	1	709404	SIDE CHANNEL ASSY. - RH
E	64	409000	AXLE CONNECTOR - FEMALE
F	64	409001	AXLE CONNECTOR - MALE
G	32	409002	CRANK ARM - LONG
H	32	409003	CRANK ARM - SHORT
I	32	409004	END CRANK - R.H.
J	32	409005	END CRANK - L.H.
K	10	212366	PUSHNUT - .250 STUD DIA.
L	2	222040	SNAP RING
M	2	709401	DIVIDER ASSEMBLY
N	1	709403	DIVIDER ASSEMBLY
O	1	709405	ADJUST. BAR ASSY - MIDDLE
P	1	709406	ADJUST. BAR ASSY - REAR
Q	124	409656	SLAT - GATEWAY LT
R	4	409207	FLAT SLAT ST
S	4	409208	FLAT SLAT LT
-	2	202191	BOLT - HEX
-	16	202510	BOLT - MACHINE HEX HD.
-	16	212189	NUT - HEX. LOCK
-	2	214130	WASHER - HEL. SPRING LOCK
-	2	214280	WASHER - ST'D. FLAT

**PART NUMBER: 002663**

REVISION I.D. : -

DESCRIPTION: JOHN DEERE 7700,7701 , 7720, 7721 CHAFFER  
PRIOR TO S/N 610500

ITEM	QTY.	PART NUMBER	DESCRIPTION
A	1	409602	REAR TUBE
B	1	709426	FRONT TUBE ASSEMBLY
C	1	709353	SIDE CHANNEL ASSY. - LH
D	1	709354	SIDE CHANNEL ASSY. - RH
E	129	409000	AXLE CONNECTOR - FEMALE
F	129	409001	AXLE CONNECTOR - MALE
G	43	409002	CRANK ARM - LONG
H	86	409003	CRANK ARM - SHORT
I	43	409004	END CRANK - R.H.
J	43	409005	END CRANK - L.H.
K	9	212366	PUSHNUT - .250 STUD DIA.
L	2	222040	SNAP RING
M	2	709355	DIVIDER ASSEMBLY
N	1	709356	DIVIDER ASSEMBLY
O	1	709357	ADJUST. BAR ASSY - MIDDLE
P	1	709358	ADJUST. BAR ASSY - REAR
Q	168	409656	SLAT - GATEWAY LT
R	4	409207	FLAT SLAT ST
S	-	-	-
-	2	202191	BOLT - HEX
-	6	202200	BOLT - MACHINE HEX HD.
-	10	202510	BOLT - MACHINE HEX HD.
-	16	212189	NUT - HEX. LOCK
-	2	214130	WASHER - HEL. SPRING LOCK
-	2	214280	WASHER - ST'D. FLAT



# SERVICE PART LIST

**PART NUMBER: 002670**

REVISION I.D. : A

DESCRIPTION: JOHN DEERE 8820 TITAN II CHAFFER

ITEM	QTY.	PART NUMBER	DESCRIPTION
A	1	709367	REAR TUBE ASSY
B	1	709351	FRONT TUBE ASSEMBLY
C	1	709361	SIDE CHANNEL ASSY. - LH
D	1	709362	SIDE CHANNEL ASSY. - RH
E	141	409000	AXLE CONNECTOR - FEMALE
F	141	409001	AXLE CONNECTOR - MALE
G	47	409002	CRANK ARM - LONG
H	94	409003	CRANK ARM - SHORT
I	47	409004	END CRANK - R.H.
J	47	409005	END CRANK - L.H.
K	10	212366	PUSHNUT - .250 STUD DIA.
L	2	222040	SNAP RING
M	2	709363	DIVIDER ASSEMBLY
N	1	709364	DIVIDER ASSEMBLY
O	1	709365	ADJUST. BAR ASSY - MIDDLE
P	1	709358	ADJUST. BAR ASSY - REAR
Q	184	409535	SLAT
R	4	409205	FLAT SLAT ST
S	-	-	-
-	2	202191	BOLT - HEX
-	6	202200	BOLT - MACHINE HEX HD.
-	10	202670	BOLT - MACHINE HEX HD.
-	16	212189	NUT - HEX. LOCK
-	2	214130	WASHER - HEL. SPRING LOCK
-	2	214280	WASHER - ST'D. FLAT
-	4	409328	FILLER PIECE

**PART NUMBER: 002673**

REVISION I.D. : A

DESCRIPTION: JOHN DEERE 8820 TITAN II CHAFFER

ITEM	QTY.	PART NUMBER	DESCRIPTION
A	1	709367	REAR TUBE ASSY
B	1	709351	FRONT TUBE ASSEMBLY
C	1	709361	SIDE CHANNEL ASSY. - LH
D	1	709362	SIDE CHANNEL ASSY. - RH
E	141	409000	AXLE CONNECTOR - FEMALE
F	141	409001	AXLE CONNECTOR - MALE
G	47	409002	CRANK ARM - LONG
H	94	409003	CRANK ARM - SHORT
I	47	409004	END CRANK - R.H.
J	47	409005	END CRANK - L.H.
K	10	212366	PUSHNUT - .250 STUD DIA.
L	2	222040	SNAP RING
M	2	709363	DIVIDER ASSEMBLY
N	1	709364	DIVIDER ASSEMBLY
O	1	709365	ADJUST. BAR ASSY - MIDDLE
P	1	709358	ADJUST. BAR ASSY - REAR
Q	184	409579	SLAT - GATEWAY LT
R	4	409205	FLAT SLAT ST
S	-	-	-
-	2	202191	BOLT - HEX
-	6	202200	BOLT - MACHINE HEX HD.
-	10	202670	BOLT - MACHINE HEX HD.
-	16	212189	NUT - HEX. LOCK
-	2	214130	WASHER - HEL. SPRING LOCK
-	2	214280	WASHER - ST'D. FLAT
-	4	409328	FILLER PIECE

**PART NUMBER: 002672**

REVISION I.D. : -

DESCRIPTION: JOHN DEERE 8820 TITAN II CHAFFER

ITEM	QTY.	PART NUMBER	DESCRIPTION
A	1	709367	REAR TUBE ASSY
B	1	709351	FRONT TUBE ASSEMBLY
C	1	709411	SIDE CHANNEL ASSY. - LH
D	1	709412	SIDE CHANNEL ASSY. - RH
E	105	409000	AXLE CONNECTOR - FEMALE
F	105	409001	AXLE CONNECTOR - MALE
G	35	409002	CRANK ARM - LONG
H	70	409003	CRANK ARM - SHORT
I	35	409004	END CRANK - R.H.
J	35	409005	END CRANK - L.H.
K	10	212366	PUSHNUT - .250 STUD DIA.
L	2	222040	SNAP RING
M	2	709413	DIVIDER ASSEMBLY
N	1	709414	DIVIDER ASSEMBLY
O	1	709415	ADJUST. BAR ASSY - MIDDLE
P	1	709416	ADJUST. BAR ASSY - REAR
Q	132	409579	SLAT - GATEWAY LT
R	8	409206	FLAT SLAT LT
S	-	-	-
-	2	202191	BOLT - HEX
-	6	202200	BOLT - MACHINE HEX HD.
-	10	202670	BOLT - MACHINE HEX HD.
-	16	212189	NUT - HEX. LOCK
-	2	214130	WASHER - HEL. SPRING LOCK
-	2	214280	WASHER - STD. FLAT

**PART NUMBER: 002675**

REVISION I.D. : A

DESCRIPTION: JOHN DEERE 7720 TITAN II CHAFFER

ITEM	QTY.	PART NUMBER	DESCRIPTION
A	1	709434	REAR TUBE ASSEMBLY
B	1	709426	FRONT TUBE ASSEMBLY
C	1	709361	SIDE CHANNEL ASSY. - LH
D	1	709362	SIDE CHANNEL ASSY. - RH
E	141	409000	AXLE CONNECTOR - FEMALE
F	141	409001	AXLE CONNECTOR - MALE
G	47	409002	CRANK ARM - LONG
H	47	409003	CRANK ARM - SHORT
I	47	409004	END CRANK - R.H.
J	47	409005	END CRANK - L.H.
K	9	212366	PUSHNUT - .250 STUD DIA.
L	2	222040	SNAP RING
M	2	709363	DIVIDER ASSEMBLY
N	1	709364	DIVIDER ASSEMBLY
O	1	709365	ADJUST. BAR ASSY - MIDDLE
P	1	709358	ADJUST. BAR ASSY - REAR
Q	184	409609	CHAFFER SLAT
R	4	409207	FLAT SLAT ST
S	-	-	-
-	2	202191	BOLT - HEX
-	6	202200	BOLT - MACHINE HEX HD.
-	10	202510	BOLT - MACHINE HEX HD.
-	16	212189	NUT - HEX. LOCK
-	2	214130	WASHER - HEL. SPRING LOCK
-	2	214280	WASHER - ST'D. FLAT
-	4	409251	FILLER PIECE

# SERVICE PART LIST

**PART NUMBER: 002677**

REVISION I.D. : -

DESCRIPTION: JOHN DEERE 7720 TITAN II CHAFFER

**PART NUMBER: 002678**

REVISION I.D. : A

DESCRIPTION: JOHN DEERE 7720 TITAN II CHAFFER

ITEM	QTY.	PART NUMBER	DESCRIPTION
A	1	709434	REAR TUBE ASSEMBLY
B	1	709426	FRONT TUBE ASSEMBLY
C	1	709411	SIDE CHANNEL ASSY. - LH
D	1	709412	SIDE CHANNEL ASSY. - RH
E	105	409000	AXLE CONNECTOR- FEMALE
F	105	409001	AXLE CONNECTOR- MALE
G	35	409002	CRANK ARM - LONG
H	70	409003	CRANK ARM - SHORT
I	35	409004	END CRANK - R.H.
J	35	409005	END CRANK - L.H.
K	11	212366	PUSHNUT - .250 STUD DIA.
L	2	222040	SNAP RING
M	2	709413	DIVIDER ASSEMBLY
N	1	709414	DIVIDER ASSEMBLY
O	1	709415	ADJUST. BAR ASSY - MIDDLE
P	1	709416	ADJUST. BAR ASSY - REAR
Q	136	409656	SLAT - GATEWAY LT
R	8	409208	FLAT SLAT LT
S	-	-	-
-	2	202191	BOLT - HEX
-	6	202200	BOLT - MACHINE HEX HD.
-	10	202510	BOLT - MACHINE HEX HD.
-	16	212189	NUT - HEX. LOCK
-	2	214130	WASHER - HEL. SPRING LOCK
-	2	214280	WASHER - ST'D. FLAT

ITEM	QTY.	PART NUMBER	DESCRIPTION
A	1	709434	REAR TUBE ASSEMBLY
B	1	709426	FRONT TUBE ASSEMBLY
C	1	709361	SIDE CHANNEL ASSY. - LH
D	1	709362	SIDE CHANNEL ASSY. - RH
E	141	409000	AXLE CONNECTOR - FEMALE
F	141	409001	AXLE CONNECTOR - MALE
G	47	409002	CRANK ARM - LONG
H	47	409003	CRANK ARM - SHORT
I	47	409004	END CRANK - R.H.
J	47	409005	END CRANK - L.H.
K	9	212366	PUSHNUT - .250 STUD DIA.
L	2	222040	SNAP RING
M	2	709363	DIVIDER ASSEMBLY
N	1	709364	DIVIDER ASSEMBLY
O	1	709365	ADJUST. BAR ASSY - MIDDLE
P	1	709358	ADJUST. BAR ASSY - REAR
Q	184	409656	SLAT - GATEWAY LT
R	4	409207	FLAT SLAT ST
S	-	-	-
-	2	202191	BOLT - HEX
-	6	202200	BOLT - MACHINE HEX HD.
-	10	202510	BOLT - MACHINE HEX HD.
-	16	212189	NUT - HEX. LOCK
-	2	214130	WASHER - HEL. SPRING LOCK
-	2	214280	WASHER - ST'D. FLAT
-	4	409251	FILLER PIECE

**PART NUMBER: 002740**

REVISION I.D. : A

DESCRIPTION: CNH E.A. NB 2A 7010, CR, CX, CHAFFER

ITEM	QTY.	PART NUMBER	DESCRIPTION
A	1	709264	REAR TUBE ASSEMBLY
B	1	709184	FRONT TUBE ASSEMBLY
C	1	709125	SIDE CHANNEL ASSY. - LH
D	1	709126	SIDE CHANNEL ASSY. - RH
E	90	409000	AXLE CONNECTOR - FEMALE
F	90	409001	AXLE CONNECTOR - MALE
G	35	409002	CRANK ARM - LONG
H	55	409003	CRANK ARM - SHORT
I	30	409004	END CRANK - R.H.
J	30	409005	END CRANK - L.H.
K	9	212366	PUSHNUT - .250 STUD DIA.
L	-	-	-
M	1	709266	DIVIDER ASSEMBLY
N	2	709188	DIVIDER ASSEMBLY
O	1	409417	ADJUST. BAR ASSY - MIDDLE
P	1	409416 OR 418	ADJUST. BAR ASSY - REAR
Q	112	409245	SLAT - GATEWAY LT
R	4	409246	FLAT SLAT ST
S	4	409249	FLAT SLAT LT
T	1	709259 OR 263	HANDLE ASSEMBLY

**IF YOU HAVE OTHER QUESTIONS:** Please contact your dealer or distributor.

You may also email or visit our website at:

e-mail: [info@hccinc.com](mailto:info@hccinc.com)

web: [www.hccinc.com](http://www.hccinc.com)

This manual is also available for download at: <http://www.hccinc.com/gateway-combine-sieves-and-combine-chaffers>

**HCC, inc.**  
1501 1<sup>ST</sup> Avenue – Mendota, Illinois 61342  
(815) 539-9371 Fax (815) 539-3135  
**WARRANTY REGISTRATION**

Delivery Date \_\_\_\_\_ Ultimate User \_\_\_\_\_

Address \_\_\_\_\_

City, State (Province) \_\_\_\_\_ Zip/Postal Code \_\_\_\_\_

Country \_\_\_\_\_ Telephone (\_\_\_\_) \_\_\_\_\_

---

---

Dealer/Distributor Name \_\_\_\_\_

Dealer/Distributor Customer Number \_\_\_\_\_ Telephone (\_\_\_\_) \_\_\_\_\_

Address \_\_\_\_\_

City, State (Province) \_\_\_\_\_ Zip/Postal Code \_\_\_\_\_

Country \_\_\_\_\_

---

---

**To be completed by DEALER / DISTRIBUTOR or ULTIMATE USER:**

**Please place an (X) in front of the product or products you are submitting this Warranty Registration form for.**

- \_\_\_\_\_ Orbit Reel \_\_\_\_\_ Product kit number
- \_\_\_\_\_ Gateway Sieve or chaffer \_\_\_\_\_ Product frame number
- \_\_\_\_\_ Reel
- \_\_\_\_\_ Other / List \_\_\_\_\_

**Please make a copy of this WARRANTY REGISTRATION form for your records and return the original to:**

**Marketing & Sales Manager  
HCC, Inc.  
1501 1<sup>ST</sup> Avenue  
Mendota, Illinois 61342 USA**

**Form must be completed and returned to HCC, Inc. within 30 days from receipt of delivery or warranty may become void.**

**HCC, inc.**  
1501 1<sup>st</sup> Avenue – Mendota, Illinois 61342  
(815) 539-9371 Fax (815) 539-3135  
**LIMITED WARRANTY**

HCC, inc. warrants each new HCC, inc. product to be free from defects in material and workmanship. This warranty is applicable only for the normal service life expectancy of the product or components, not to exceed 12 consecutive months from the date of delivery of the new HCC, inc. product to the original purchaser.

Genuine HCC, inc. replacement parts and components will be warranted for 90 days from date of purchase, or the remainder of the original equipment warranty period, whichever is longer. There is no warranty for tines.

Under no circumstances will it cover any merchandise or components thereof, which, in the opinion of the company, has been subjected to misuse, unauthorized modifications, alteration, an accident, or if repairs have been made with parts other than those obtainable through HCC, inc.

Our obligation under this warranty shall be limited to repairing or replacing, free of charge to the original purchaser, any part that, in our judgment, shall show evidence of such defect, provided further that such part shall be returned within thirty (30) days from date of failure to HCC, inc., routed through the dealer and distributor from whom the purchase was made, transportation charges prepaid.

This warranty shall not be interpreted to render HCC, inc. liable for injury or damages of any kind or nature to person or property. This warranty does not extend to the loss of crops, loss because of delay in harvesting, or any expense or loss incurred for labor, substitute machinery, rental, or for any other reason.

Except as set forth above, **HCC, inc. shall have no obligation or liability of any kind on account of any of its equipment and shall not be liable for special or consequential damages. HCC, inc. makes no other warranty, expressed or implied, and specifically, HCC, inc. disclaims any implied warranty of merchantability or fitness for a particular purpose. Some states or provinces do not permit limitations or exclusions of implied warranties or incidental or consequential damages, so the limitations or exclusion in this warranty may not apply.**

This warranty is subject to any existing conditions of supply which may directly affect our ability to obtain materials or manufacture replacement parts.

HCC, inc. reserves the right to make improvements in design or changes in specifications at any time, without incurring any obligation to owners of units previously sold.

No one is authorized to alter, modify, or enlarge this warranty nor the exclusion, limitations, and reservations.

**Effective with products delivered to original user on or after January 1, 2006**